

BEVILL STATE COMMUNITY COLLEGE

**1411 INDIANA AVENUE
JASPER AL 35501**

Corrected

**BID REQUEST #05-2025 Weatherization Training Lab
DATE TO OPEN: November 26, 2024
TIME OF OPENING: 3:00 P.M.**

**SUBMIT BID PROPOSAL TO:
RHONDA PORTER
BEVILL STATE COMMUNITY COLLEGE
1411 INDIANA AVENUE
McCUTCHEON HALL, ROOM 210
JASPER AL 35501**

BEVILL STATE COMMUNITY COLLEGE will receive sealed bids in the Purchasing Department until 3:00 P.M., for the items described in the bid invitation. Bids will be publicly opened and placed on display. Any questions regarding this bid should be directed to **Rhonda Porter** at (205) 387-0511, Ext **5246**

<u>CONTENTS</u>	<u>PAGE</u>
General Conditions and Instructions to Bidders	2
Vendor Information/Qualification Statement	4
Damage/Non-Performance Clause	5
Disclosure Statement	7
Specifications	Attached

**IN ORDER TO BE ACCEPTED, ALL BIDS MUST BE RECEIVED IN THE
PURCHASING DEPARTMENT AT MCCUTCHEON HALL – ROOM #210
1411 INDIANA AVENUE
JASPER AL 35501**

A BID BOND IS REQUIRED ON ALL BID QUOTES OF \$10,000 OR MORE

GENERAL CONDITIONS AND INSTRUCTIONS TO BIDDERS

In accordance with Act No. 2001-637, when state funds are used to fund a contract, preference must be given to resident contractors. Resident contractors must be granted preference to nonresidents in awarding contracts in the same manner as the states of nonresident contractors. Alabama Law (Section 41-4-116, Code of Alabama 1975) provides that every bid submitted and contract executed shall contain a certification that the vendor, contractor, and all of its affiliates that make sales for delivery into Alabama or leases for use in Alabama are registered, collecting, and remitting Alabama state and local sales, use, and/or lease tax on all taxable sales and leases into Alabama. By submitting this bid, the bidder is hereby certifying that they are in full compliance with Act No. 2006-557. They are not barred from bidding or entering into a contract pursuant to 41-4-116, and acknowledge that the awarding authority may declare the contract void if the certification is false. In compliance with Act 2016-312, the contractor hereby certifies that it is not currently engaged in, and will not engage in, the boycott of a person or an entity based in or doing business with a jurisdiction with which this state can enjoy open trade.

1. All bids are to be in sealed envelopes with the above bid number and opening dates on the outside of the envelope. Mark your bid to the attention of **Rhonda Porter**.
2. Only written modifications to proposals will be accepted.

Bidders may submit proposals on any one or all items listed.
However, the College reserves the right to select *and purchase individual items*.

3. All bid prices are to be quoted F.O.B., Beville State Community College, at place of installation.
4. The College reserves the right to accept or reject any bid or part thereof and waive informalities that may be deemed in the best interest of the College.
5. **References in the specifications to name brands, catalogue numbers, etc., are for identification purposes only and in no way are intended to eliminate or discourage the offering of substitute items, which equal the specifications.**
6. If quotations are offered on substitute items, the bidder must include catalogues/brochures with complete descriptions and manufacturers' specifications.
7. Guarantees/warranties are to be furnished by the vendor as provided by the manufacturer.
8. Bid prices are not to include tax. Tax exemption certificates furnished upon request.
9. All items are to be free from defects in material and workmanship. If items are defective or damaged or do not meet the specification, they are to be replaced immediately by the vendor at no additional cost to the College.
10. No payments on partial shipments will be made until all items have been received in good condition.

11. This proposal is to be made without connection with any other person, company or parties making a bid or proposal and is to be in all respects fair and in good faith, without collusion or fraud.
12. The contractor must comply with all Federal, State, County and City laws regarding license fees and agreements.
13. All bids \$10,000 and over must be accompanied with a Bid Bond in the amount of 5% of bid, not to exceed \$10,000. (Use high amount when figuring bid amount). After awarding the contract, the Bid Bond will be returned.
14. Bid must be submitted on appropriate page(s) of this document and all pages returned to be considered.
15. Each bidder will be required to complete a Disclosure Statement as required by Act 2001-955. Act 2001-955 requires the disclosure statement to be completed and filed with all proposals, bids, contracts, or grant proposals to the State of Alabama in excess of \$5,000.
- 16. The provider of services and/or goods shall be fully responsible for any harm, loss, damage or injury to the property of or persons of Bevill State Community College resulting from their actions under this contract and shall be liable for the reasonable costs of repair, replacement or restoration of the premises. This is in addition to any other legal or equitable recovery for loss.**
- 17. In the event of non-performance, partial performance or inadequate performance, the provider of goods and/or services shall be liable to Bevill State Community College for all costs of completion of the project or acquisition of goods by another provider and any consequential damages or losses due to the passage of time past the due date. This is in addition to any other legal or equitable recovery to which Bevill State Community College is entitled.**
- 18. By signing this contract, the contracting parties affirm, for the duration of the agreement, that they will not violate federal immigration law or knowingly employ, hire for employment, or continue to employ an unauthorized alien within the State of Alabama. Furthermore, a contracting party found to be in violation of this provision shall be deemed in breach of the agreement and shall be responsible for all damages resulting therefrom.**

VENDOR INFORMATION & QUALIFICATION

Vendor Name		
Address – Street, City, State and Zip)		
Contact Numbers	Telephone	Fax
Email Address		
Signature of person Submitting Bid		
Typed name of Person Submitting Bid		
Position or Title of Person Submitting Bid		

Offer to Bevill State Community College, Alabama
Quotations are F.O.B. to ALL locations.

PAYMENT TERMS:

MINORITY INFORMATION

If this business is minority owned please specify the status below:

I certify that I have read all the General Conditions and Instructions to Bidders of this bid and this offer is made without prior understanding, or connection with any entity or person submitting a bid for the same materials, supplies or equipment, and is in all respects fair and without collusion or fraud. I am authorized to sign this bid for the bidder. I agree to abide by all conditions of this bid request.

Name of Company
(Please type or print in ink)

Authorized Signature
(Sign in ink)

DAMAGE & NON-PERFORMANCE CLAUSE

The provider of services and/or goods shall be fully responsible, to the extent allowed by law, for any harm, loss, damage or injury to the property or persons of Bevill State Community College that may result, either directly or indirectly, from the installation at the sites and location specified in any contract that may result from the bidding process. Further, the provider of such services and/or goods shall be responsible for the costs of any repairs, replacement or restoration to the premises that is determined to be caused by such installation.

In the event of non-performance, partial performance or inadequate performance of the provider, the provider of such services and/or goods, shall be liable to Bevill State Community College for all costs of installation of equipment and ensuring that all is working properly and in accordance with all specifications and functions.

However, the provider and Bevill State Community College hereby acknowledge that there has not been a waiver of any warranties, either expressed or implied, and both parties agree to exhaust all remedies available under such warranties before other legal or equitable recovery is attempted.

VENDOR NAME

AUTHORIZED SIGNATURE

NOTARIZATION REQUIRED

Sworn and subscribed before me this the _____ day of _____, 2011.

Notary Public

My commission expires

Vendor Disclosure Statement Information and Instructions

Act 2001-955 requires the disclosure statement to be completed and filed with all proposals, bids, contracts, or grant proposals to the State of Alabama in excess of \$5,000. The disclosure statement is not required for contracts for gas, water, and electric services where no competition exists, or where rates are fixed by law or ordinance. In circumstances where a contract is awarded by competitive bid, the disclosure statement shall be required only from the person receiving the contract and shall be submitted within ten (10) days of the award.

The State of Alabama shall not enter into any contract or appropriate any public funds with any person who refuses to provide information required by Act 2001-955.

Pursuant to Act 2001-955, any person who knowingly provides misleading or incorrect information on the disclosure statement shall be subject to a civil penalty of ten percent (10%) of the amount of the transaction, not to exceed \$10,000.00. Also, the contract or grant shall be voidable by the awarding entity.

Definitions as Provided in Act 2001-955

Family Member of a Public Employee - Spouse or a dependent of the public employee.

Family Member of a Public Official - The spouse, a dependent, an adult child and his or her spouse, a parent, a spouse's parents, a sibling and his or her spouse, of the public official.

Family Relationship - A person has a family relationship with a public official or public employee if the person is a family member of the public official or public employee.

Person - An individual, firm, partnership, association, joint venture, cooperative, or corporation, or any other group or combination acting in concert.

Public Official and Public Employee - These terms shall have the same meanings ascribed to them in Sections 36-25-1(23) and 36-25-1(24), Code of Alabama 1975, (see below) except for the purposes of the disclosure requirements of this act, the terms shall only include persons in a position to influence the awarding of a grant or contract who are affiliated with the awarding entity. Notwithstanding the foregoing, these terms shall also include the Governor, Lieutenant Governor, members of the cabinet of the Governor, and members of the Legislature.

Section 36-25-1(23), Code of Alabama 1975, defines a public employee as any person employed at the state, county or municipal level of government or their instrumentalities, including governmental corporations and authorities, but excluding employees of hospitals or other health care corporations including contract employees of those hospitals or other health care corporations, who is paid in whole or in part from state, county, or municipal funds. For purposes of this chapter, a public employee does not include a person employed on a part-time basis whose employment is limited to providing professional services other than lobbying, the compensation for which constitutes less than 50 percent of the part-time employee's income.

Section 36-25-1(24), Code of Alabama 1975, defines a public official as any person elected to public office, whether or not that person has taken office, by the vote of the people at state, county, or municipal level of government or their instrumentalities, including governmental corporations, and any person appointed to a position at the state, county, or municipal level of government or their instrumentalities, including governmental corporations. For purposes of this chapter, a public official includes the chairs and vice-chairs or the equivalent offices of each state political party as defined in Section 17-16-2, Code of Alabama 1975.

Instructions

Complete all lines as indicated. If an item does not apply, denote N/A (not applicable). If you cannot include required information in the space provided, attach additional sheets as necessary.

The form must be signed, dated, and notarized prior to submission.



State of Alabama Disclosure Statement

(Required by Act 2001-955)

ENTITY COMPLETING FORM

ADDRESS

CITY, STATE, ZIP

TELEPHONE NUMBER

FAX NUMBER

()

()

STATE AGENCY/DEPARTMENT THAT WILL RECEIVE GOODS, SERVICES, OR IS RESPONSIBLE FOR GRANT AWARD

BEVILL STATE COMMUNITY COLLEGE

ADDRESS

1411 INDIANA AVENUE

CITY, STATE, ZIP

TELEPHONE NUMBER

JASPER AL 35501

800-648-3271

This form is provided with:

Contract

Proposal

Request for Proposal

Invitation to Bid

Grant Proposal

Have you or any of your partners, divisions, or any related business units previously performed work or provided goods to any State Agency/Department in the current or last fiscal year?

Yes No

If yes, identify below the State Agency/Department that received the goods or services, the type(s) of goods or services previously provided, and the amount received for the provision of such goods and services.

STATE AGENCY/DEPARTMENT	TYPE OF GOODS/SERVICES	AMOUNT RECEIVED

Have you or any of your partners, divisions, or any related business units previously applied and received any grants from any State Agency/Department in the current or last fiscal year?

Yes No

If yes, identify below the State Agency/Department that awarded the grant, the date such grant was awarded, and the amount of the grant.

STATE AGENCY/DEPARTMENT	TYPE OF GOODS/SERVICES	AMOUNT RECEIVED

- List below the name(s) and address(es) of all public officials/public employees with whom you, members of your immediate family, or any of your employees have a family relationship and who may directly personally benefit financially from the proposed transaction. Identify the State Department/Agency for which the public officials/public employees work. (Attach additional sheets if necessary).

NAME OF PUBLIC OFFICIAL/EMPLOYEE	ADDRESS	STATE DEPARTMENT/AGENCY
----------------------------------	---------	-------------------------

2. List below the name(s) and address(es) of all family members of public officials/public employees with whom you, members of your immediate family, or any of your employees have a family relationship and who may directly personally benefit financially from the proposed transaction. Identify the public officials/public employees and State Department/Agency for which the public officials/public employees work. (Attach additional sheets if necessary.)

NAME OF FAMILY MEMBER	ADDRESS	NAME OF PUBLIC OFFICIAL/PUBLIC EMPLOYEE	STATE DEPARTMENT/AGENCY WHERE EMPLOYED
-----------------------	---------	---	--

If you identify individuals in item one and/or two above, describe in detail below the direct financial benefit to be gained by the public officials, public employees, and/or family members as the result of the contract, proposal, request for proposal, invitation to bid, or grant proposal. (Attach additional sheets if necessary.)

Describe in detail below any indirect financial benefits to be gained by any public official, public employee, and/or family members of the public official or public employee as the result of the contract, proposal, request for proposal, invitation to bid, or grant proposal. (Attach additional sheets if necessary.)

List below the name(s) and address(es) of all paid consultants and/or lobbyists utilized to obtain the contract, proposal, request for proposal, invitation to bid, or grant proposal:

By signing below, I certify under oath and penalty of perjury that all statements on or attached to this form are true and correct to the best of my knowledge. I further understand that a civil penalty of ten percent (10%) of the amount of the transaction, not to exceed \$10,000.00, is applied for knowingly providing incorrect or misleading information. If any of the above information changes prior to September 30, 2010, I will notify the awarding agency in writing at the time of the change.

Signature _____ Date _____

Notary's Signature _____ Date _____ Date Notary Expires _____

Act 2001-955 requires the disclosure statement to be completed and filed with all proposals, bids, contracts, or grant proposals to the State of Alabama in excess of \$5,000.

**PLEASE MAIL COMPLETED FORM TO: Bevill State Community College
Purchasing Department
1411 Indiana Ave
Jasper, AL 35501**

BID SPECIFICATIONS

Bevill State Community College is seeking to purchase two (2) or more of the following:

Specs are on the following pages.

If you have any questions regarding these specifications please contact Cameron.Cox@bscc.edu or by phone at (205) 3870-511 x 7791.

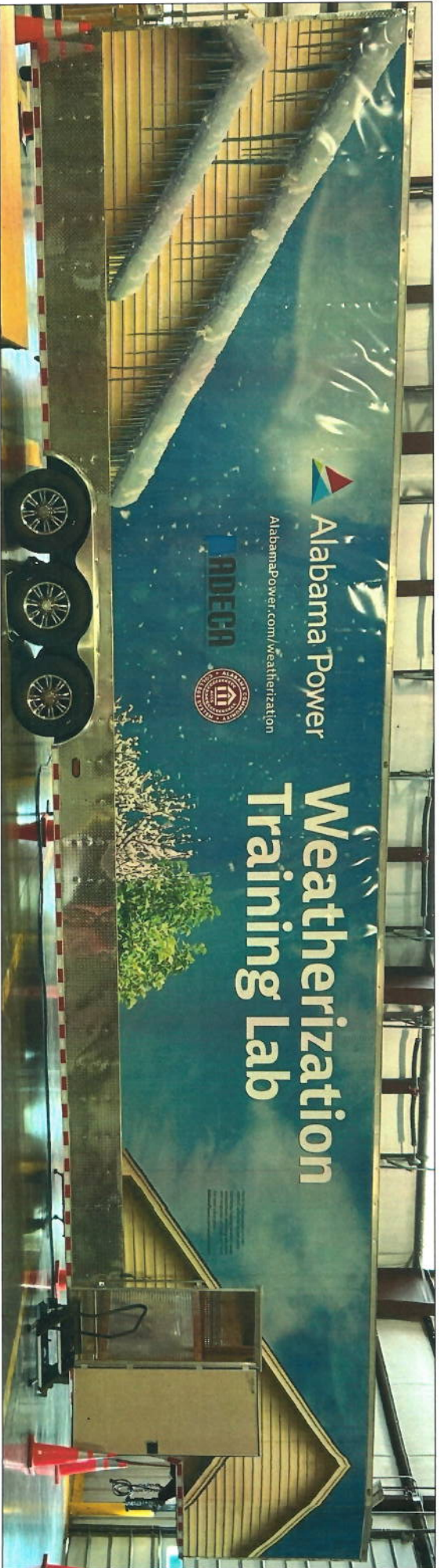

Alabama Power

AlabamaPower.com/Weatherization

ADECA



Weatherization Training Lab

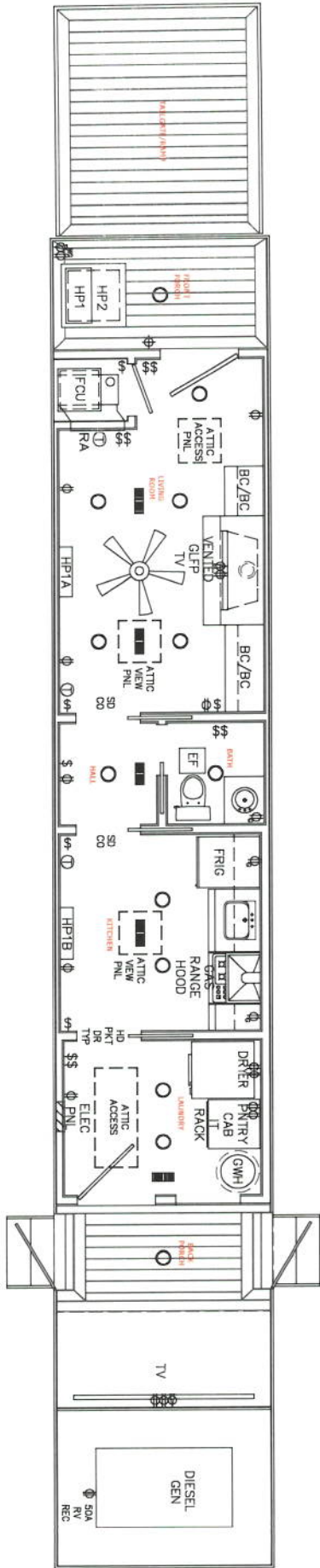

FLOOR PLAN

BEVILL STATE COMMUNITY COLLEGE
MOBILE WEATHERIZATION TRAINING LAB





- ITEM DESCRIPTION:
- 1 Ceiling
 - 2 - Spruce 5/4 186 V Groove
 - 3 - Whitewash Stain / Clear Satin Polyurethane
 - 4 Tailgate Hour
 - 5 Trim
 - 6 - 1x4 Burnished Barnwood
 - 7 Tailgate Hot Control Panel
 - 8 Bathroom Vent Cap
 - 9 Woodgrain Siding
 - 10 scalloped woodgrain siding
 - 11 Attic Vent
 - 12 Furnace elbow combustion air intake vent
 - 13 - two one light / one box
 - 14 Recessed LED Light Fixture (overhead)
 - 15 Wall Mounted Light Fixture
 - 16 Tailgate Hot Control Station
 - 17 Craftsman Series Front Door
 - 18 Faux Rock Veneer
 - 19 Mini Split Heat Pump - 24K BTU
 - 20 Decorative Heat Pump Stand
 - 21 AC Disconnect - 1hp 2
 - 22 Heat Pump Condensing Unit - 24K BTU
 - 23 Decorative Heat Pump Pad/Stand
 - 24 Trex Composite Decking - [Gravel Path]

TAILGATE RAMP / FRONT PORCH



- ITEM DESCRIPTION:
- 39 Recessed Light
 - 40 Bathroom
 - 41 Mirror
 - 42 Vanity Faucet
 - 43 Undermount Vanity Sink
 - 44 Quartz Vanity Top
 - 45 Vanity Cabinet
 - 46 Hotel Style Toilet
 - 47 HD Pocket Door
 - 48 - Craftsman Series Solid Door Slab
 - 49 - Glass White
 - 50 Decora Light Switches and GFCI receptacle

BATH



- ITEM DESCRIPTION:
- 21 Ceiling Fan with Light Kit [44"]
 - 22 Ceiling
 - 23 - Spruce 5/4 186 V Groove
 - 24 - Whitewash Stain / Clear Satin Polyurethane
 - 25 HVAC Supply Register
 - 26 Trim
 - 27 - Crown Moulding [Gloss White]
 - 28 - Door Trim [Gloss White]
 - 29 - Baseboard [Gloss White]
 - 30 - Attic Access
 - 31 Recessed Lighting
 - 32 Mini Split Wall Cassette - 12K BTU
 - 33 Walls
 - 34 - Pine Nickel Gap Shiplap
 - 35 - Rubbed Kit, 2 Clear Satin Polyurethane
 - 36 - Corner Butt Moulding [Gloss White]
 - 37 Thermostat - Split System Heat Pump
 - 38 Decora Light Switches
 - 39 TV
 - 40 Return Grille - Split System Heat Pump
 - 41 Cedar Mantle
 - 42 Gas Logs Fire Place - Vented through roof
 - 43 Commercial Gauge LVF flooring
 - 44 Faux Rock Fireplace and Hearth Veneer
 - 45 Faux Rock Wheel Well Veneer
 - 46 Base Cabinet with Bookcase - both sides



LIVING ROOM





- ITEM DESCRIPTION:
- 49 Kitchen Cabinets
 - 50 Range Hood
 - 51 24" Gas Range - Propane
 - 52 Kitchen Base cabinet
 - 53 Quartz Counter Top
 - 54 Undermount Bar Sink with Faucet
 - 55 24" Refrigerator
 - 56 Mini Split Wall Cassette - 12K BTU
 - 57 Thermostat - Mini Split
 - 58 Decora Switch

KITCHEN



- ITEM DESCRIPTION:
- 59 Combination Washer Dryer
 - 60 Utility Pantry Cabinet
 - 61 Utility Pantry Cabinet - Top Half - FT Back
 - 61 Utility Pantry Cabinet - Bottom Half - Storage
 - 62 Gas Water Heater - Propane
 - 63 Insulation Demonstration Window - Vented Through Roof
 - 64 24x36 Window
 - 65 Not Shown - Craftsman Series Rear Door
 - 66 Not Shown - Pull Down Attic Access
 - 67 Not Shown - Electrical Panel

LAUNDRY



- ITEM DESCRIPTION:
- 68 66" UMD TV
 - 69 Slow Strap Bracket
 - 70 Anodized Aluminum diamond plate
 - 71 Burnished Barnwood trim
 - 72 Diamond pattern rubber mat

BACK PORCH





LEFT SIDE

ITEM DESCRIPTION:

73	RV Steps with Handrail - Both sides
74	Cold Water Inlet / Drain
75	Hot Water Drain
76	Gray Water Tank / Dump Valve
77	AC Systems Condensation Drain

BEVILL STATE COMMUNITY COLLEGE
MOBILE WEATHERIZATION TRAINING LAB



A4

